

EXISTING EXTERNAL WINDOW SCHEDULE

Window reference No :

WG-04

Floor level :

Ground

External window type :

Type 02

HISTORICAL SIGNIFICANCE

Level of significance

1=low,
5=high

1

2

3

4

5

Approximate date :

C 1860

Description :

WORKS PROPOSED

Two panel window with central stone pier and metal framed window to both LHS and RHS with no opening light

Retained and repaired :

Removed and replaced :

YES. SECONDARY
GLAZING TO BE
PROVIDED

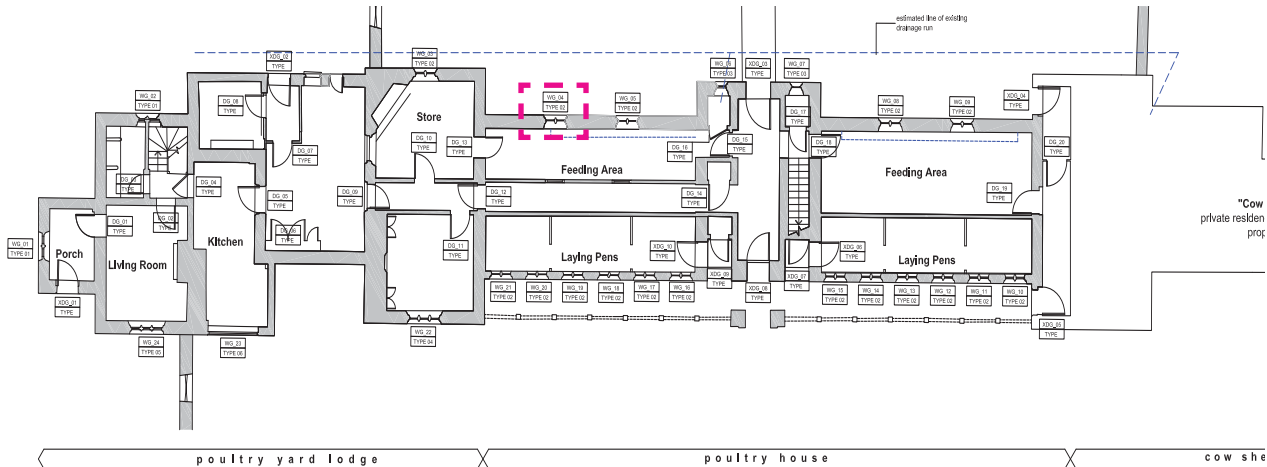

EXISTING EXTERNAL WINDOW SCHEDULE

Window reference No :

WG-05

Floor level :

Ground

External window type :

Type 02

HISTORICAL SIGNIFICANCE

Level of significance

1=low,
5=high

1

2

3

4

5

Approximate date :

C 1860

Description :

WORKS PROPOSED

Two panel window with central stone pier and metal framed window to both LHS and RHS with no opening light.

Retained and repaired :

Removed and replaced :

YES. SECONDARY
GLAZING TO BE
PROVIDED

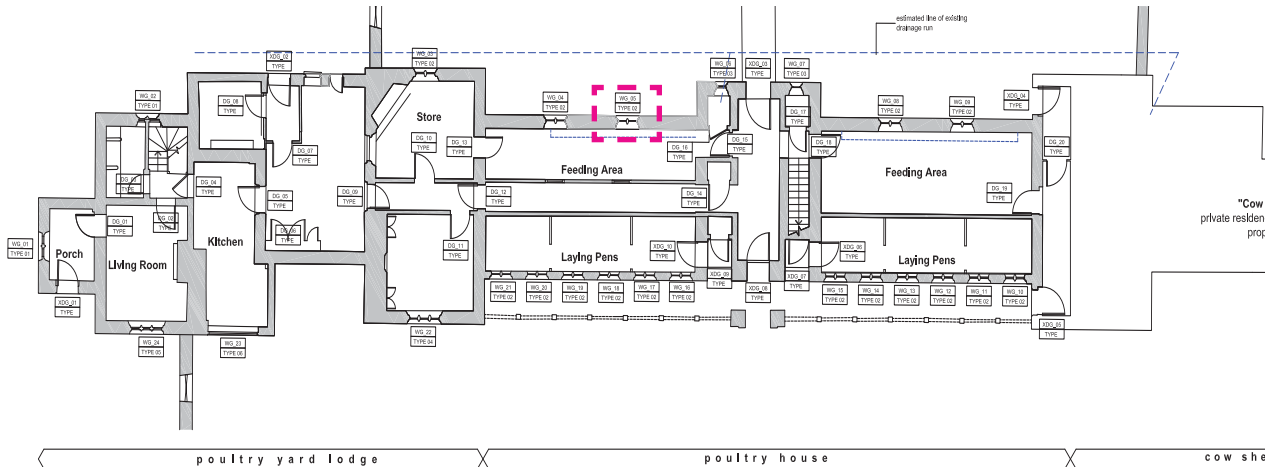
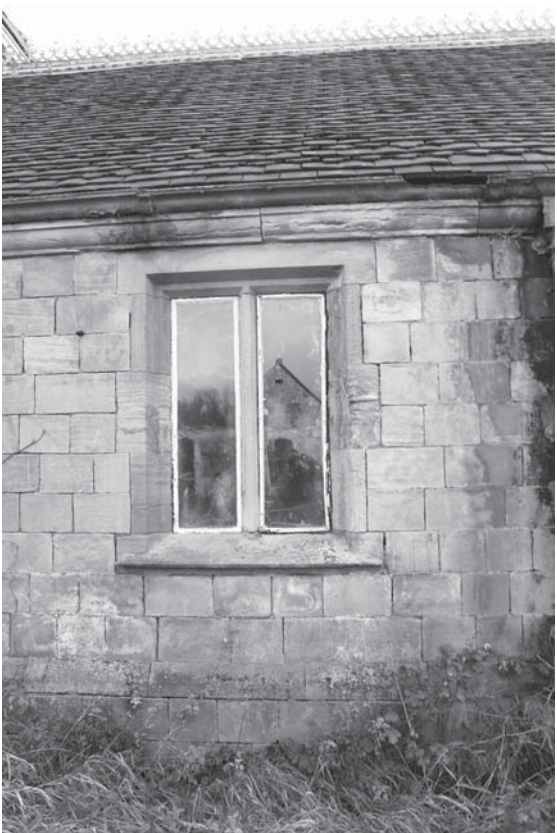

EXISTING EXTERNAL WINDOW SCHEDULE									
Window reference No :							WG-06		
Floor level :	Ground		External window type :		Type 03				
HISTORICAL SIGNIFICANCE			Level of significance	1=low, 5=high	1	2	3	4	5
Approximate date :	C 1860							4	
Description :			WORKS PROPOSED						
Single panel metal framed window with opening light			Retained and repaired :		Removed and replaced :				
			YES. SECONDARY GLAZING TO BE PROVIDED						

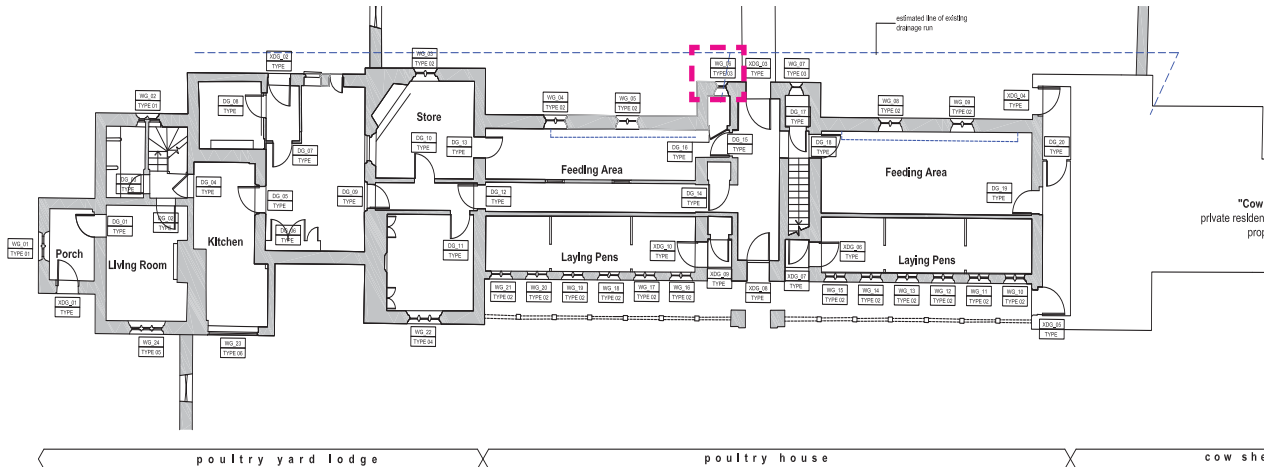
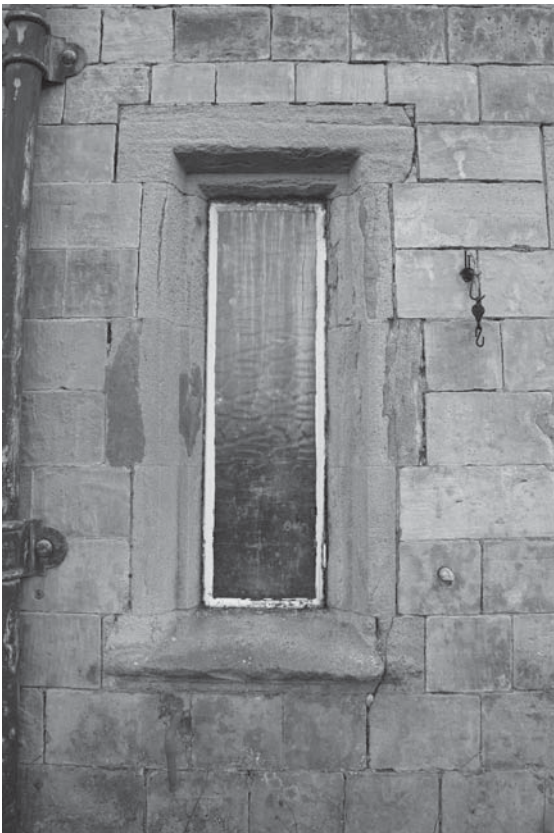

EXISTING EXTERNAL WINDOW SCHEDULE									
Window reference No :					WG-07				
Floor level :	Ground		External window type :		Type 03				
HISTORICAL SIGNIFICANCE			Level of significance	1=low, 5=high	1	2	3	4	5
Approximate date :	C 1860							4	
Description :			WORKS PROPOSED						
Single panel metal framed window with no opening light.			Retained and repaired :		Removed and replaced :				
			YES. SECONDARY GLAZING TO BE PROVIDED						

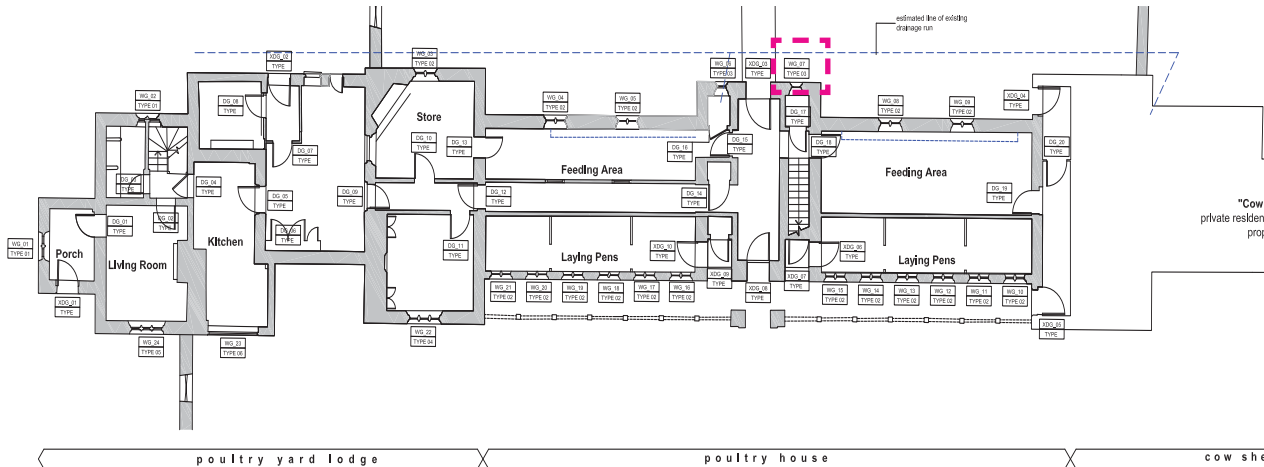

EXISTING EXTERNAL WINDOW SCHEDULE							
Window reference No :			WG-08				
Floor level :	Ground	External window type :		Type 02			
HISTORICAL SIGNIFICANCE		Level of significance	1=low, 5=high	1	2	3	4
Approximate date :	C 1860						4
Description :		WORKS PROPOSED					
Two panel window with central stone pier and metal framed window to both LHS and RHS with no opening light.		Retained and repaired :		Removed and replaced :			
		YES. SECONDARY GLAZING TO BE PROVIDED					

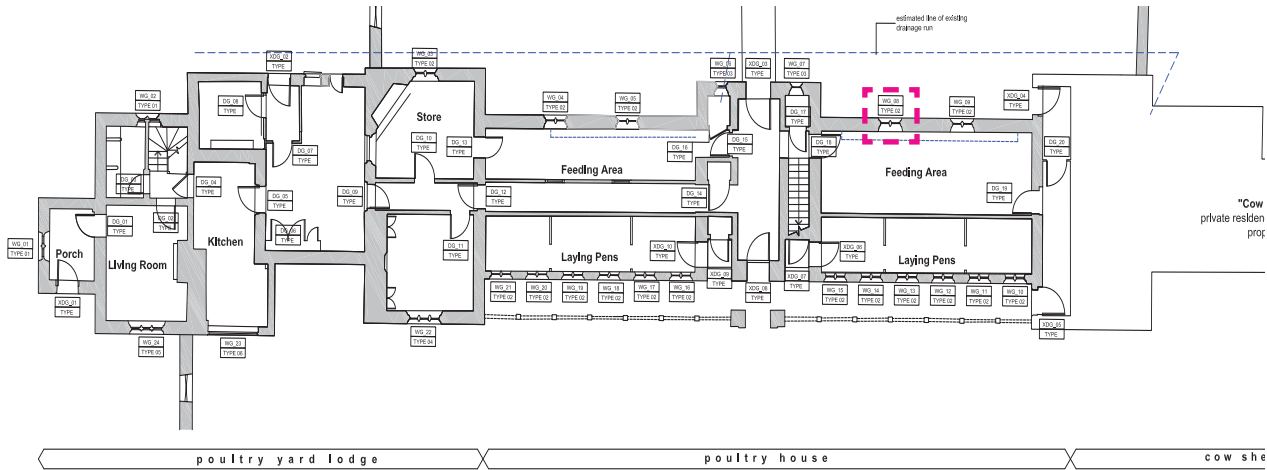

EXISTING EXTERNAL WINDOW SCHEDULE						
Window reference No :			WG-09			
Floor level :	Ground	External window type :		Type 02		
HISTORICAL SIGNIFICANCE		Level of significance	1=low, 5=high	1	2	3
Approximate date :	C 1860					4
Description :		WORKS PROPOSED				
Two panel window with central stone pier and metal framed window to both LHS and RHS with no opening light.		Retained and repaired :		Removed and replaced :		
		YES. SECONDARY GLAZING TO BE PROVIDED				

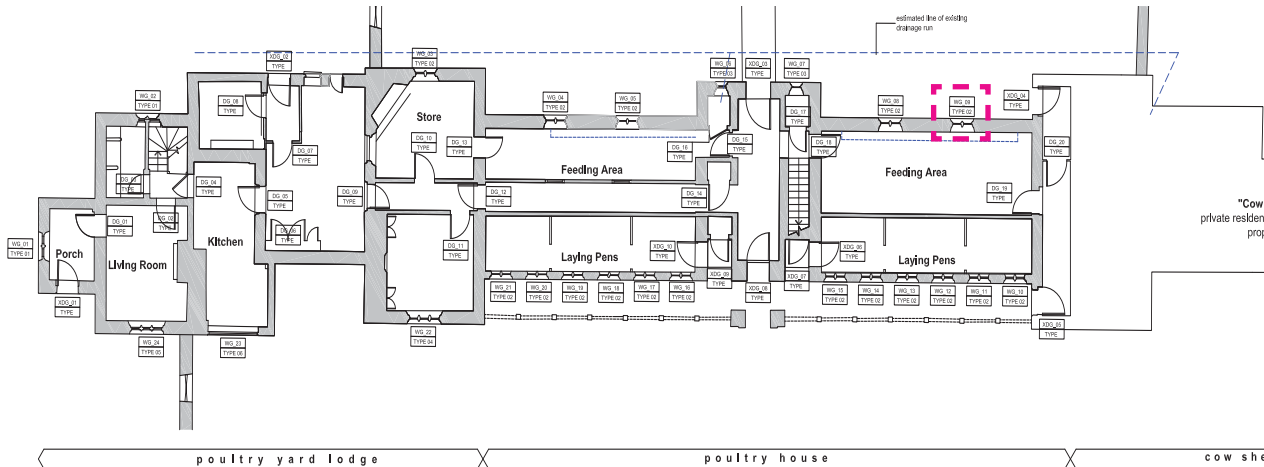

EXISTING EXTERNAL WINDOW SCHEDULE

Window reference No :

WG-10

Floor level :

Ground

External window type :

Type 02

HISTORICAL SIGNIFICANCE

Level of significance

1=low,
5=high

1

2

3

4

5

Approximate date :

C 1860

Description :

WORKS PROPOSED

Two panel window with central stone pier and metal framed window to both LHS and RHS with no opening light.

Retained and repaired :

Removed and replaced :

**YES. SECONDARY
GLAZING TO BE
PROVIDED**

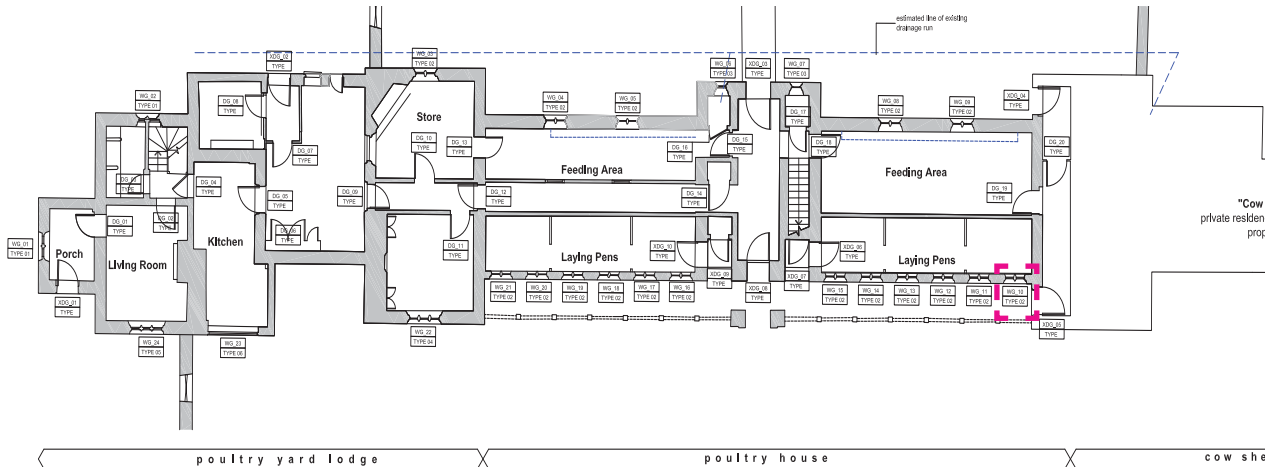

EXISTING EXTERNAL WINDOW SCHEDULE

Window reference No :

WG-11

Floor level :

Ground

External window type :

Type 02

HISTORICAL SIGNIFICANCE

Level of significance

1=low,
5=high

1

2

3

4

5

Approximate date :

C 1860

Description :

WORKS PROPOSED

Two panel window with central stone pier and metal framed window to both LHS and RHS with no opening light.

Retained and repaired :

Removed and replaced :

**YES. SECONDARY
GLAZING TO BE
PROVIDED**

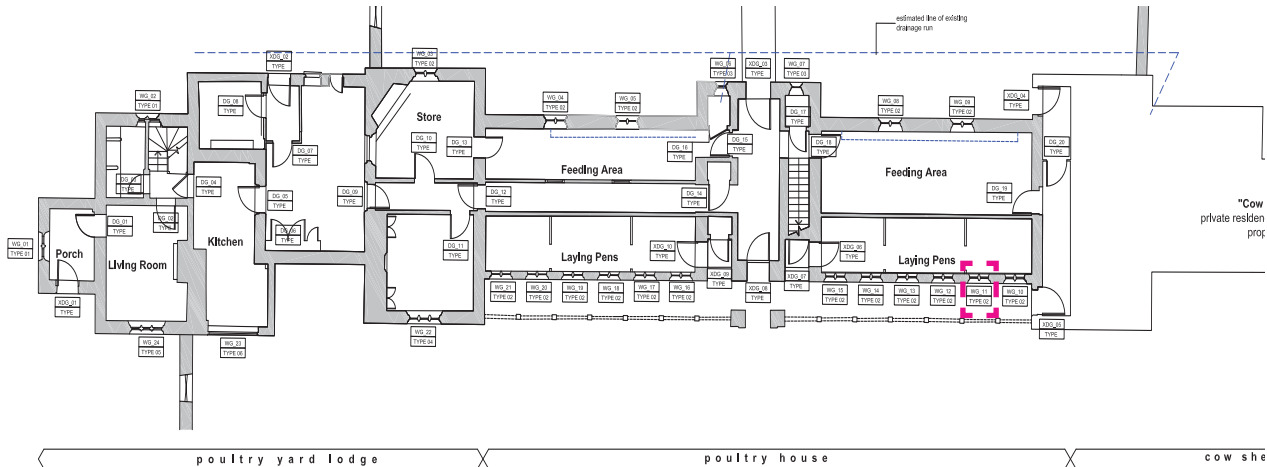

EXISTING EXTERNAL WINDOW SCHEDULE

Window reference No :

WG-12

Floor level :

Ground

External window type :

Type 02

HISTORICAL SIGNIFICANCE

Level of significance

1=low,
5=high

1

2

3

4

5

Approximate date :

C 1860

Description :

WORKS PROPOSED

Two panel window with central stone pier and metal framed window to both LHS and RHS with no opening light.

Retained and repaired :

Removed and replaced :

YES. SECONDARY
GLAZING TO BE
PROVIDED

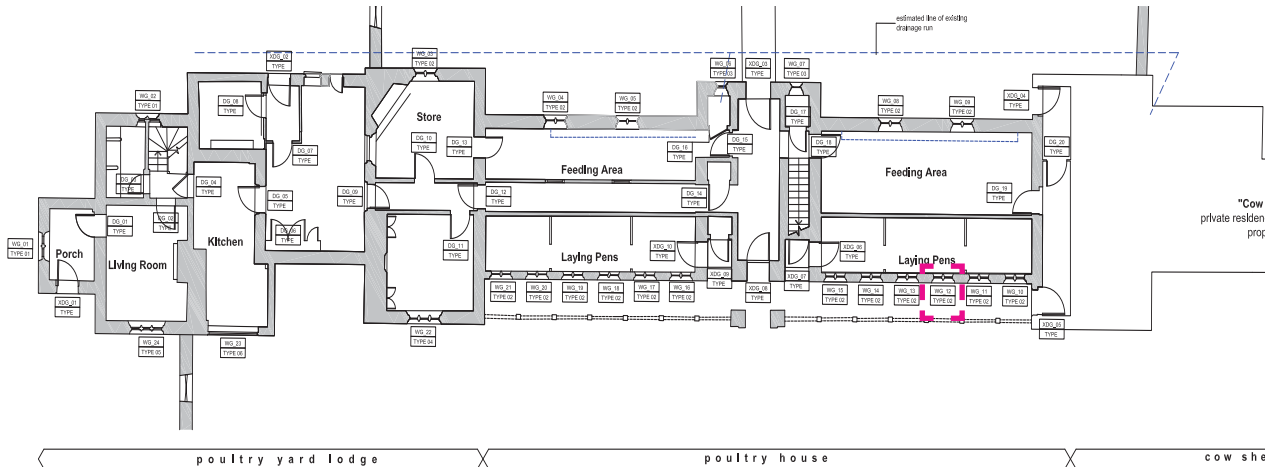
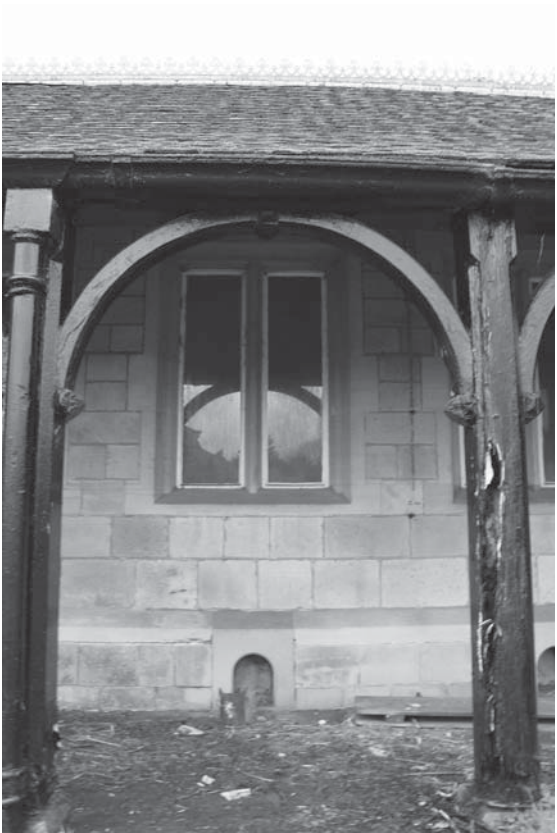

EXISTING EXTERNAL WINDOW SCHEDULE

Window reference No :

WG-13

Floor level :

Ground

External window type :

Type 02

HISTORICAL SIGNIFICANCE

Level of significance

1=low,
5=high

1

2

3

4

5

Approximate date :

C 1860

Description :

WORKS PROPOSED

Two panel window with central stone pier and metal framed window to both LHS and RHS with no opening light.

Retained and repaired :

Removed and replaced :

**YES. SECONDARY
GLAZING TO BE
PROVIDED**

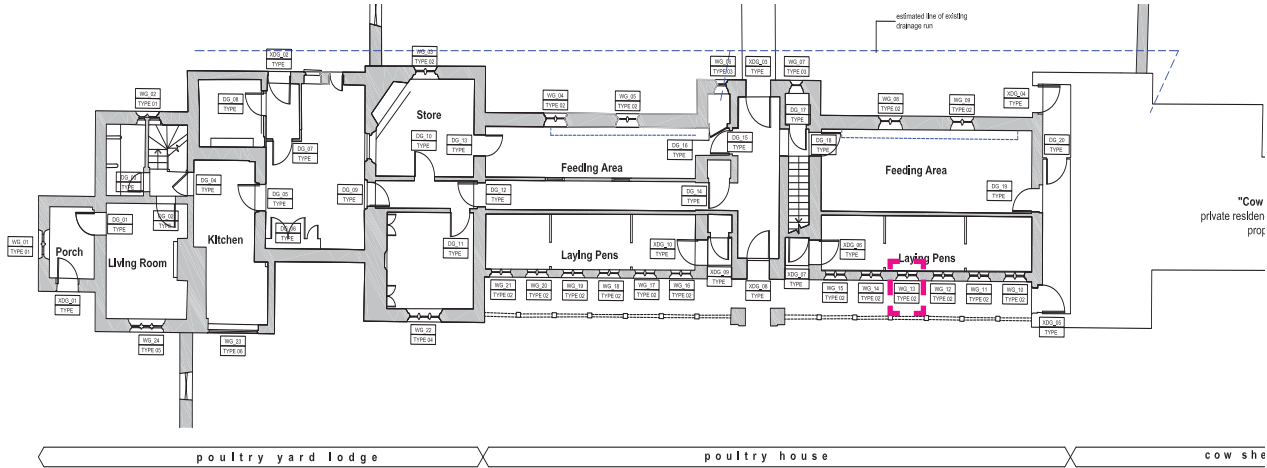

EXISTING EXTERNAL WINDOW SCHEDULE

Window reference No :

WG-14

Floor level :

Ground

External window type :

Type 02

HISTORICAL SIGNIFICANCE

Level of significance

1=low,
5=high

1

2

3

4

5

Approximate date :

C 1860

Description :

WORKS PROPOSED

Two panel window with central stone pier and metal framed window to both LHS and RHS with no opening light.

Retained and repaired :

Removed and replaced :

**YES. SECONDARY
GLAZING TO BE
PROVIDED**

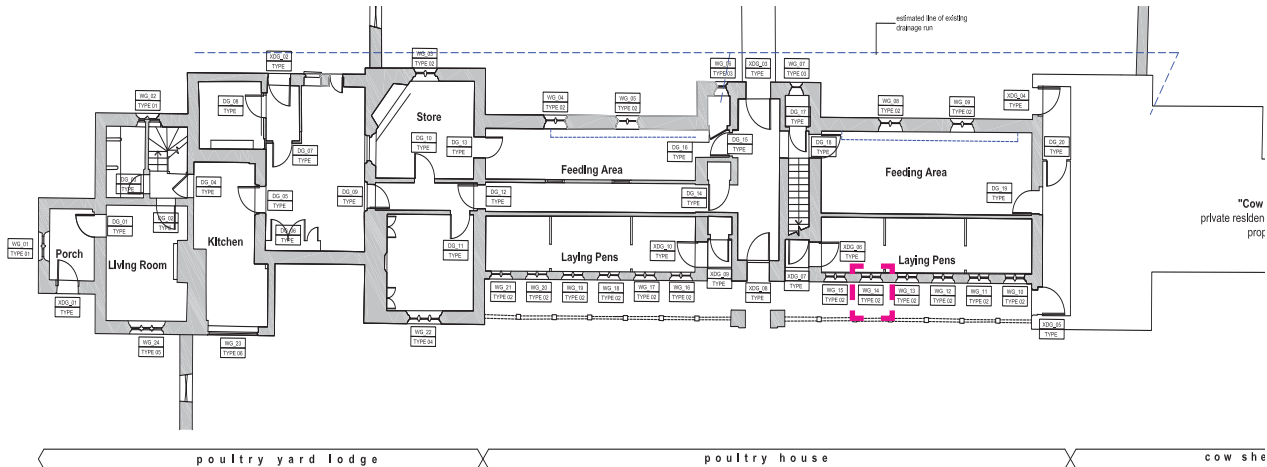

EXISTING EXTERNAL WINDOW SCHEDULE									
Window reference No :					WG-15				
Floor level :	Ground		External window type :		Type 02				
HISTORICAL SIGNIFICANCE			Level of significance	1=low, 5=high	1	2	3	4	5
Approximate date :	C 1860								5
Description :			WORKS PROPOSED						
Two panel window with central stone pier and metal framed window to both LHS and RHS with no opening light.			Retained and repaired :		Removed and replaced :				
			YES. SECONDARY GLAZING TO BE PROVIDED						

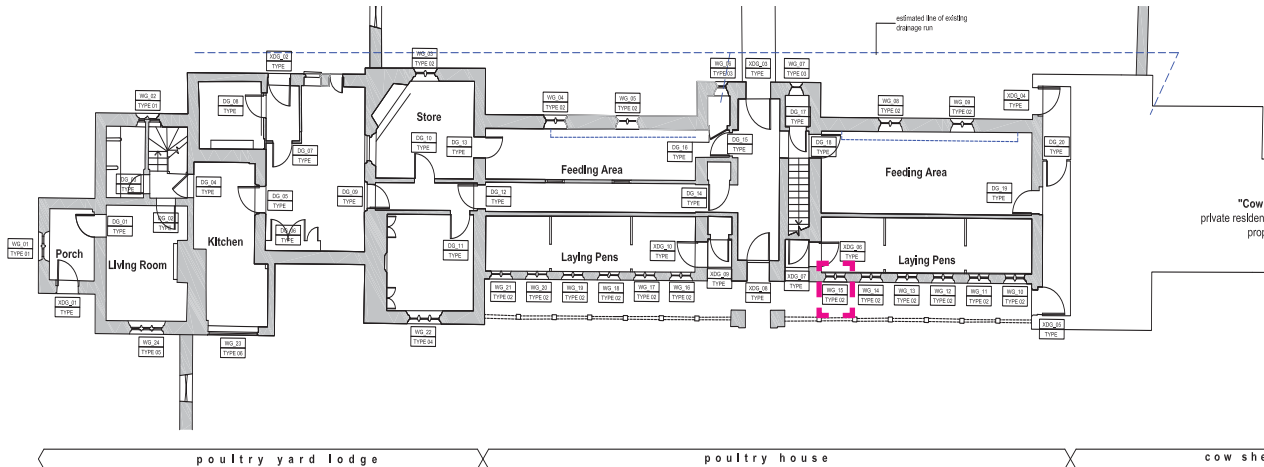

EXISTING EXTERNAL WINDOW SCHEDULE

Window reference No :

WG-16

Floor level :

Ground

External window type :

Type 02

HISTORICAL SIGNIFICANCE

Level of significance

1=low,
5=high

1

2

3

4

5

Approximate date :

C 1860

Description :

WORKS PROPOSED

Two panel window with central stone pier and metal framed window to both LHS and RHS with no opening light.

Retained and repaired :

Removed and replaced :

YES. SECONDARY
GLAZING TO BE
PROVIDED

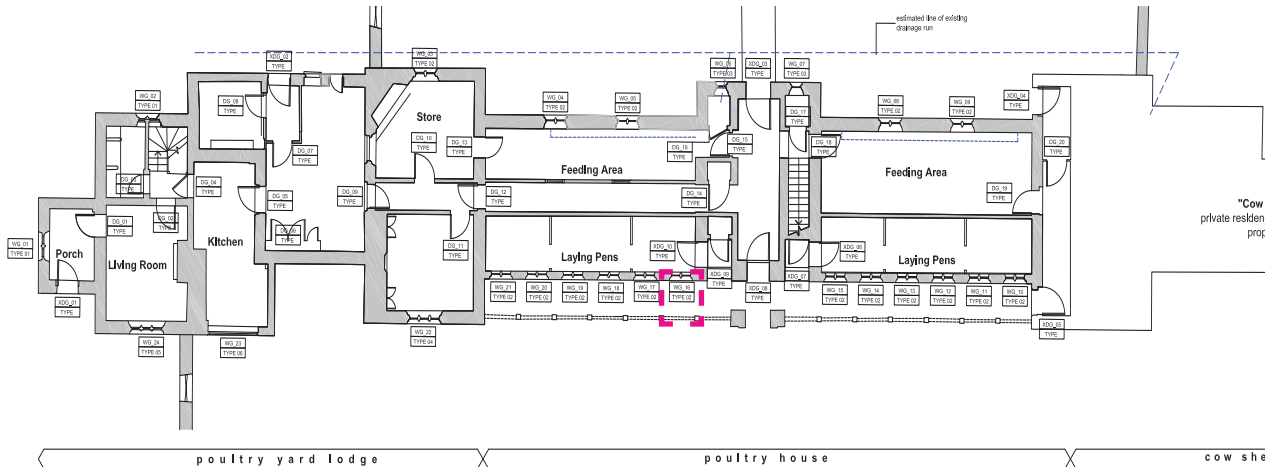
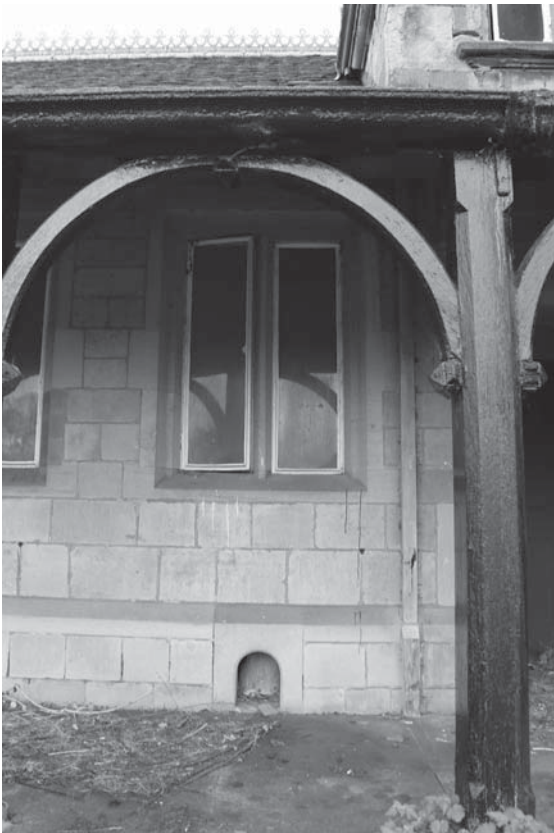

EXISTING EXTERNAL WINDOW SCHEDULE

Window reference No :

WG-17

Floor level :

Ground

External window type :

Type 02

HISTORICAL SIGNIFICANCE

Level of significance

1=low,
5=high

1

2

3

4

5

Approximate date :

C 1860

Description :

WORKS PROPOSED

Two panel window with central stone pier and metal framed window to both LHS and RHS with no opening light.

Retained and repaired :

Removed and replaced :

YES. SECONDARY
GLAZING TO BE
PROVIDED

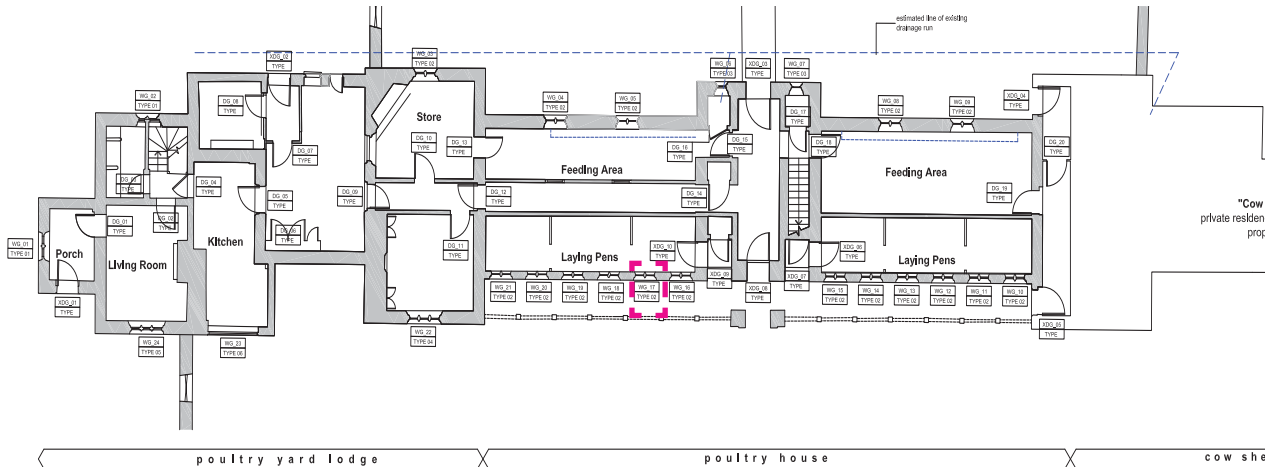

EXISTING EXTERNAL WINDOW SCHEDULE

Window reference No :

WG-18

Floor level :

Ground

External window type :

Type 02

HISTORICAL SIGNIFICANCE

Level of significance

1=low,
5=high

1

2

3

4

5

Approximate date :

C 1860

Description :

WORKS PROPOSED

Two panel window with central stone pier and metal framed window to both LHS and RHS with no opening light.

Retained and repaired :

Removed and replaced :

YES. SECONDARY
GLAZING TO BE
PROVIDED

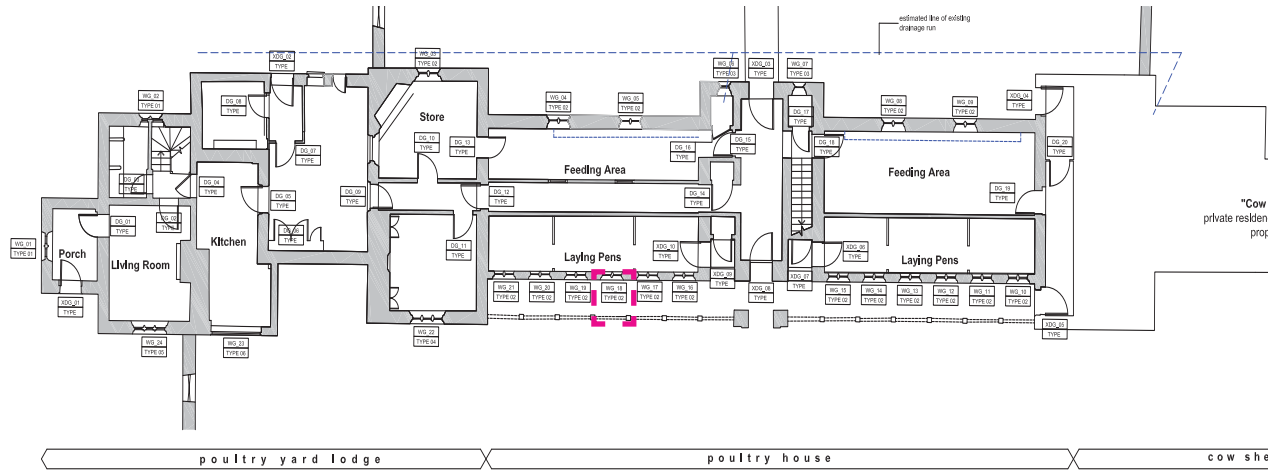
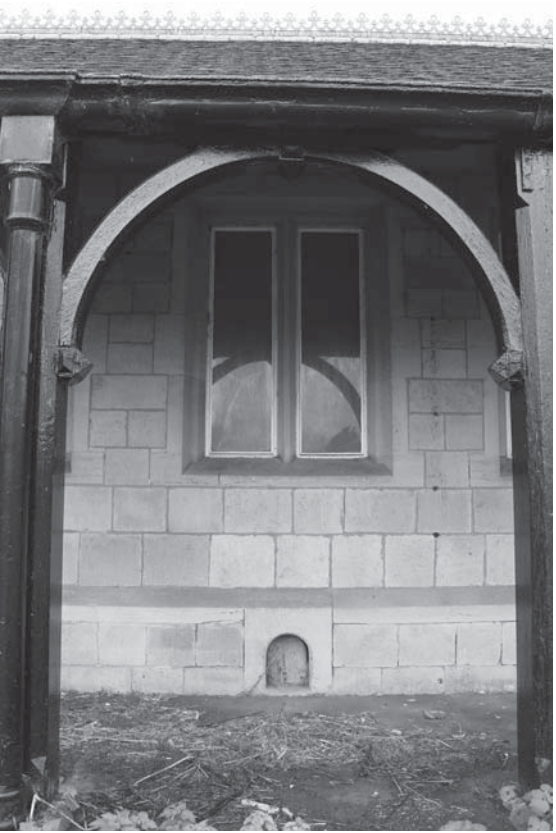

EXISTING EXTERNAL WINDOW SCHEDULE								
Window reference No :					WG-19			
Floor level :	Ground	External window type :		Type 02				
HISTORICAL SIGNIFICANCE		Level of significance	1=low, 5=high	1	2	3	4	5
Approximate date :	C 1860							5
Description :		WORKS PROPOSED						
Two panel window with central stone pier and metal framed window to both LHS and RHS with no opening light.		Retained and repaired :		Removed and replaced :				
		YES. SECONDARY GLAZING TO BE PROVIDED						

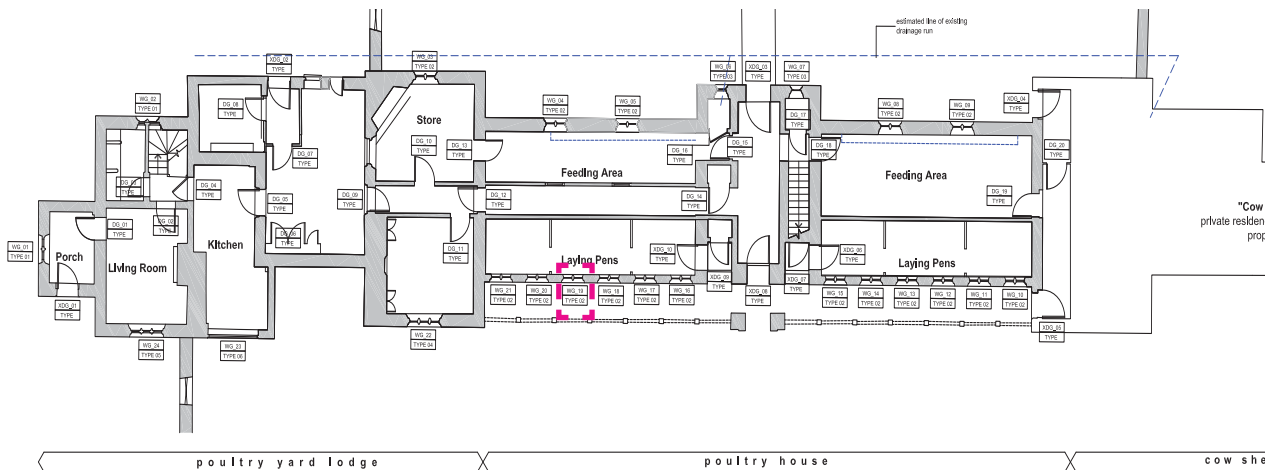

EXISTING EXTERNAL WINDOW SCHEDULE

Window reference No :

WG-20

Floor level :

Ground

External window type :

Type 02

HISTORICAL SIGNIFICANCE

Level of significance

1=low,
5=high

1

2

3

4

5

Approximate date :

C 1860

Description :

WORKS PROPOSED

Two panel window with central stone pier and metal framed window to both LHS and RHS with no opening light.

Retained and repaired :

Removed and replaced :

**YES. SECONDARY
GLAZING TO BE
PROVIDED**

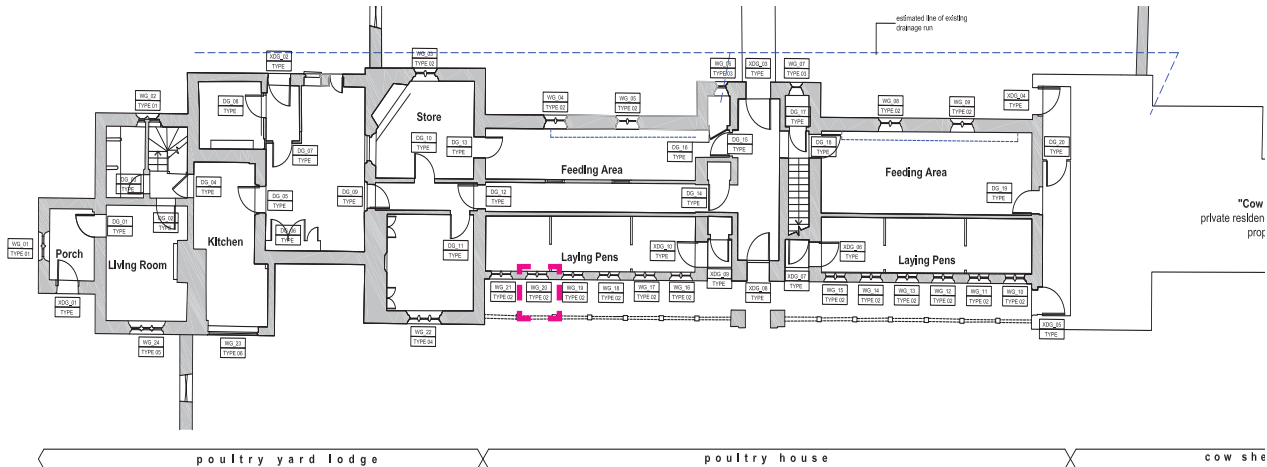
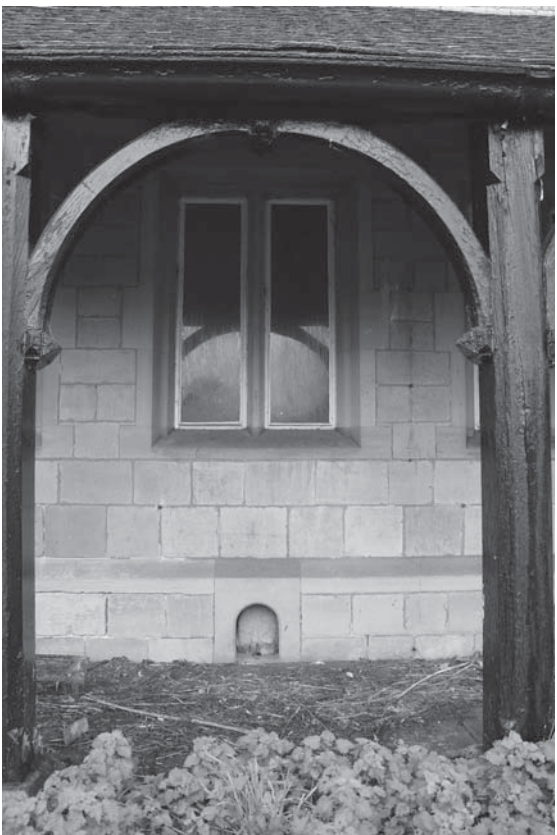

EXISTING EXTERNAL WINDOW SCHEDULE

Window reference No :

WG-21

Floor level :

Ground

External window type :

Type 02

HISTORICAL SIGNIFICANCE

Level of significance

1=low,
5=high

1

2

3

4

5

Approximate date :

C 1860

Description :

WORKS PROPOSED

Two panel window with central stone pier and metal framed window to both LHS and RHS with no opening light.

Retained and repaired :

Removed and replaced :

YES. SECONDARY
GLAZING TO BE
PROVIDED

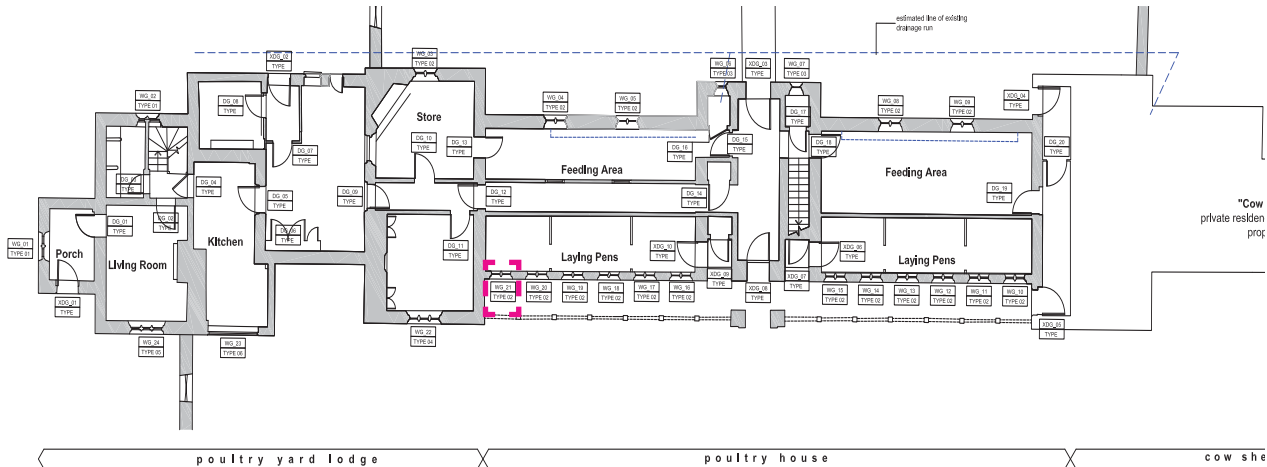

EXISTING EXTERNAL WINDOW SCHEDULE

Window reference No :

WG-22

Floor level :

Ground

External window type :

Type 04

HISTORICAL SIGNIFICANCE

Level of significance

1=low,
5=high

1

2

3

4

5

Approximate date :

C 1860

Description :

WORKS PROPOSED

Three panel window with two stone piers and metal framed window to all windows with no opening lights.

Retained and repaired :

Removed and replaced :

**YES. SECONDARY
GLAZING TO BE
PROVIDED**

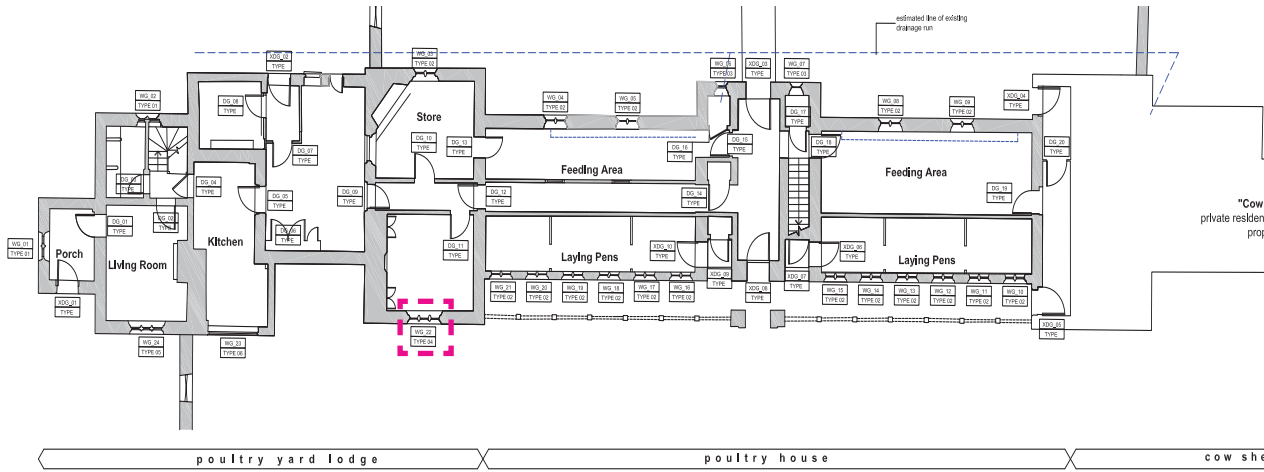

EXISTING EXTERNAL WINDOW SCHEDULE

Window reference No :

WG-23

Floor level :

Ground

External window type :

Type 06

HISTORICAL SIGNIFICANCE

Level of significance

1=low,
5=high

1

2

3

4

5

Approximate date :

C 1900's

Description :

WORKS PROPOSED

Four panel later addition timber framed windows with high level opening lights to LHS and RHS windows

Retained and repaired :

Removed and replaced :

YES. SECONDARY
GLAZING TO BE
PROVIDED

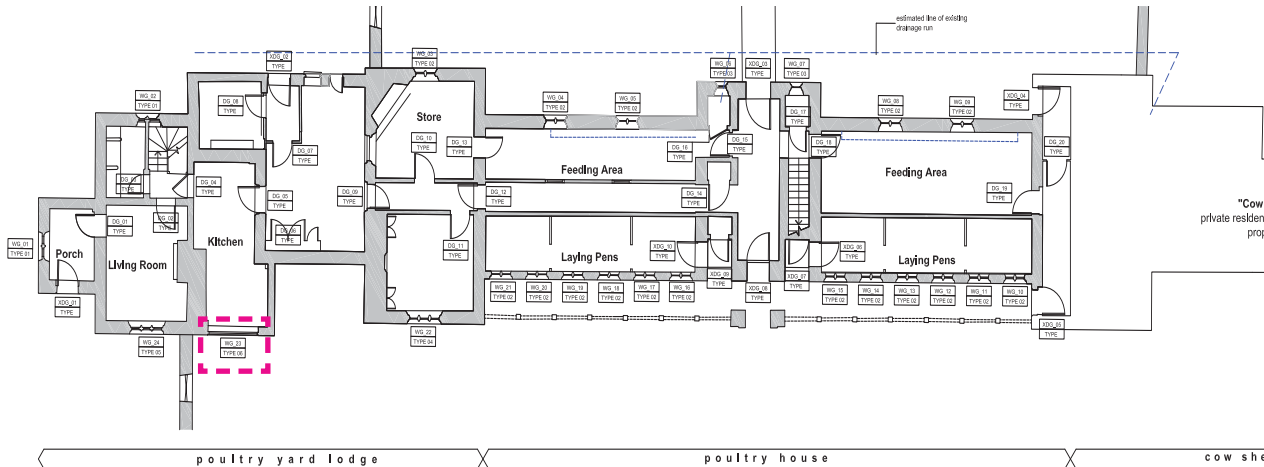

EXISTING EXTERNAL WINDOW SCHEDULE										
Window reference No :						WG-24				
Floor level :	Ground		External window type :			Type 05				
HISTORICAL SIGNIFICANCE			Level of significance		1=low, 5=high	1	2	3	4	5
Approximate date :		C 1860								
Description :			WORKS PROPOSED							
Three panel window with two stone piers and metal framed window to RHS window, later addition timber framed windows to central and LHS to provide opening lights.			Retained and repaired :		Removed and replaced :					
			YES. SECONDARY GLAZING TO BE PROVIDED							

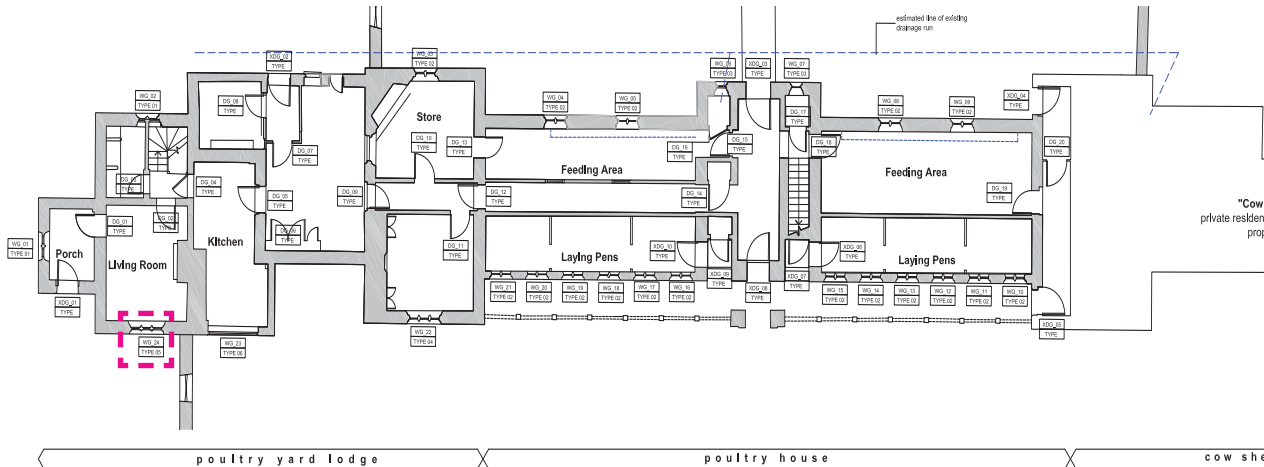

EXISTING EXTERNAL WINDOW SCHEDULE										
Window reference No :						WG-25				
Floor level :	Ground		External window type :		Type 08					
HISTORICAL SIGNIFICANCE			Level of significance		1=low, 5=high	1	2	3	4	5
Approximate date :	C 1900's						2			
Description :			WORKS PROPOSED							
9 Panel georgian style window with high level opening light. Very poor condition.			Retained and repaired :		Removed and replaced :					
					Existing windows in a very poor state of repair. Existing windows to be removed and replaced with new windows to match existing type 07.					

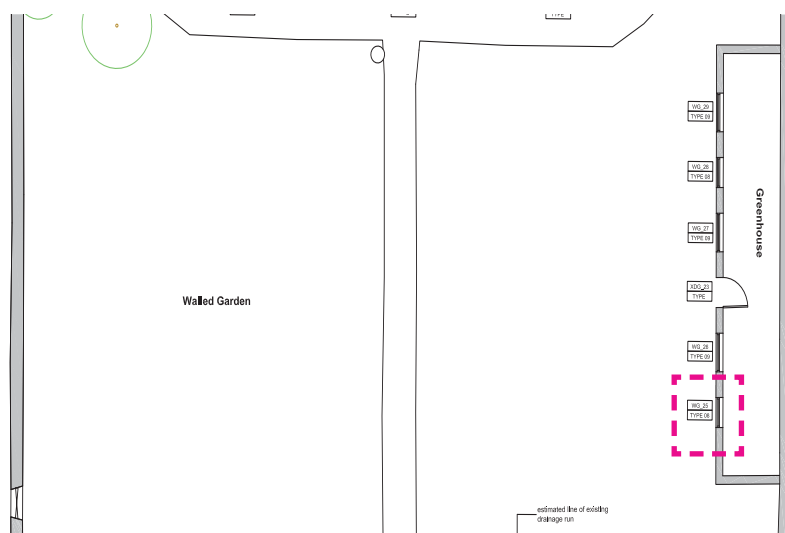

EXISTING EXTERNAL WINDOW SCHEDULE										
Window reference No :						WG-26				
Floor level :	Ground		External window type :		Type 09					
HISTORICAL SIGNIFICANCE			Level of significance		1=low, 5=high	1	2	3	4	5
Approximate date :	C 1900's						2			
Description :			WORKS PROPOSED							
10 Panel georgian style window fully opening with central rotational hinges. Very poor condition.			Retained and repaired :		Removed and replaced :					
					Existing windows in a very poor state of repair. Existing windows to be removed and replaced with new windows to match existing type 07.					

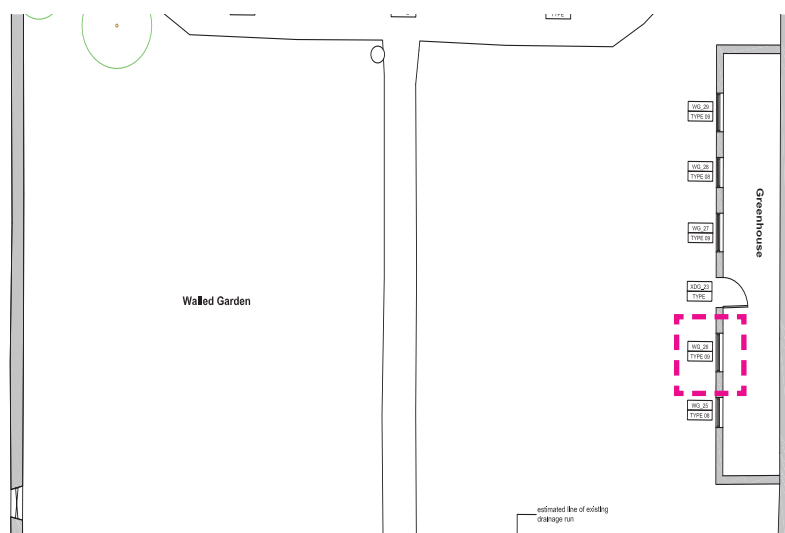

EXISTING EXTERNAL WINDOW SCHEDULE										
Window reference No :						WG-27				
Floor level :	Ground		External window type :		Type 09					
HISTORICAL SIGNIFICANCE			Level of significance		1=low, 5=high	1	2	3	4	5
Approximate date :	C 1900's						2			
Description :			WORKS PROPOSED							
10 Panel georgian style window fully opening with central rotational hinges. Very poor condition.			Retained and repaired :		Removed and replaced :					
					Existing windows in a very poor state of repair. Existing windows to be removed and replaced with new windows to match existing type 07.					

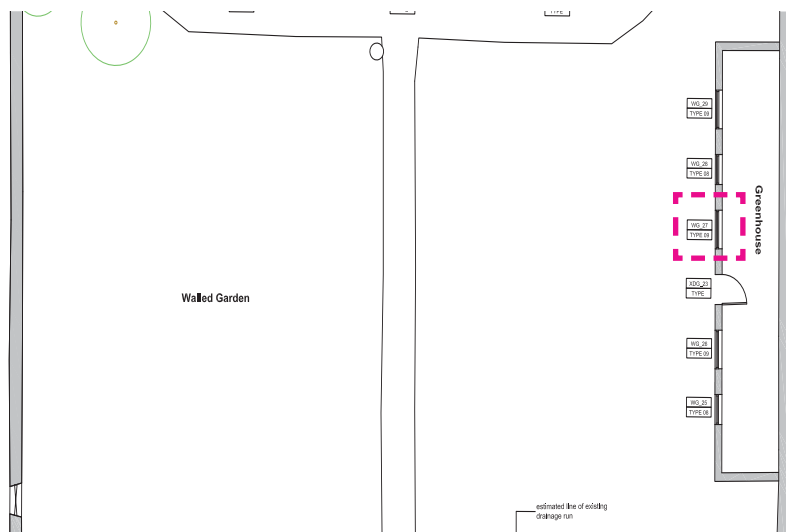

EXISTING EXTERNAL WINDOW SCHEDULE										
Window reference No :						WG-28				
Floor level :	Ground		External window type :		Type 08					
HISTORICAL SIGNIFICANCE			Level of significance		1=low, 5=high	1	2	3	4	5
Approximate date :	C 1900's						2			
Description :			WORKS PROPOSED							
9 Panel georgian style window with high level opening light. Very poor condition.			Retained and repaired :		Removed and replaced :					
					Existing windows in a very poor state of repair. Existing windows to be removed and replaced with new windows to match existing type 07.					

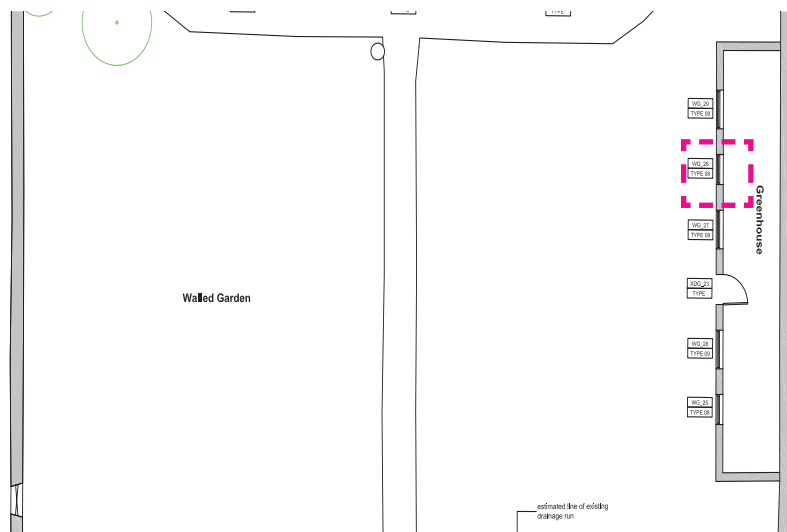

EXISTING EXTERNAL WINDOW SCHEDULE										
Window reference No :						WG-29				
Floor level :	Ground		External window type :		Type 09					
HISTORICAL SIGNIFICANCE			Level of significance		1=low, 5=high	1	2	3	4	5
Approximate date :	C 1900's						2			
Description :			WORKS PROPOSED							
10 Panel georgian style window fully opening with central rotational hinges. Very poor condition.			Retained and repaired :		Removed and replaced :					
					Existing windows in a very poor state of repair. Existing windows to be removed and replaced with new windows to match existing type 07.					

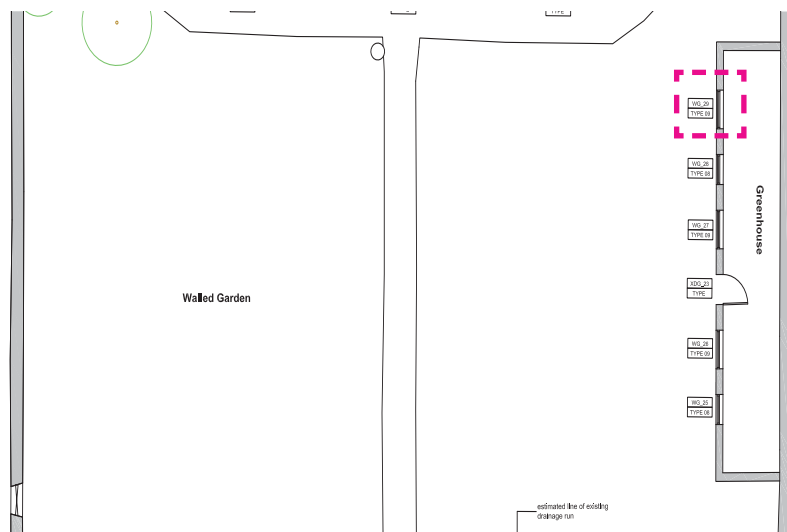

EXISTING EXTERNAL WINDOW SCHEDULE										
Window reference No :						WG-30				
Floor level :	Ground		External window type :		Type 02					
HISTORICAL SIGNIFICANCE			Level of significance		1=low, 5=high	1	2	3	4	5
Approximate date :		C 1860							4	
Description :			WORKS PROPOSED							
Two panel window with central stone pier and metal framed window to both LHS and RHS with no opening light			Retained and repaired :		Removed and replaced :					
			YES. SECONDARY GLAZING TO BE PROVIDED							

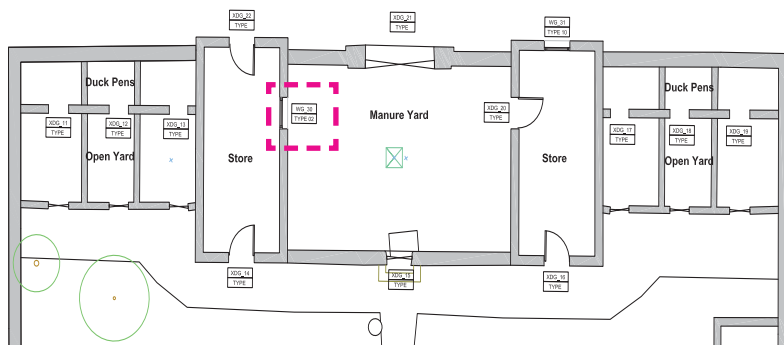

EXISTING EXTERNAL WINDOW SCHEDULE										
Window reference No :						WG-31				
Floor level :	Ground		External window type :		Type 10					
HISTORICAL SIGNIFICANCE			Level of significance		1=low, 5=high	1	2	3	4	5
Approximate date :		C 1860							4	
Description :			WORKS PROPOSED							
Three panel timber window, fully opening pivot hinge with metal restrictor internally.			Retained and repaired :		Removed and replaced :					
			YES. SECONDARY GLAZING TO BE PROVIDED							

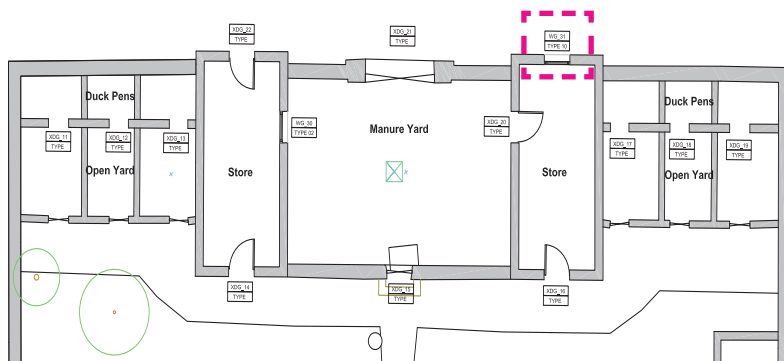
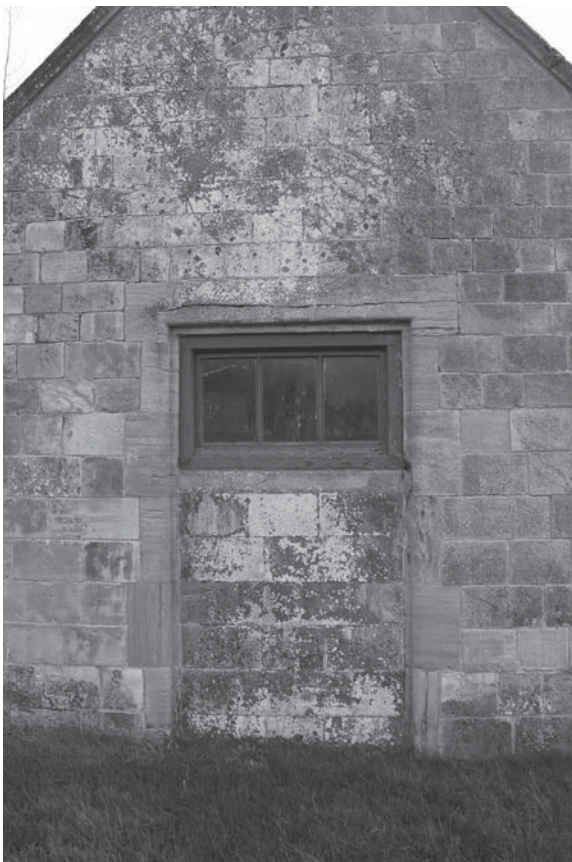

EXISTING EXTERNAL WINDOW SCHEDULE										
Window reference No :						WF-01				
Floor level :	First		External window type :		Type 01					
HISTORICAL SIGNIFICANCE			Level of significance		1=low, 5=high	1	2	3	4	5
Approximate date :		C 1860							4	
Description :			WORKS PROPOSED							
Two panel window with central stone pier and metal framed windows with opening light to RHS			Retained and repaired :		Removed and replaced :					
			YES. SECONDARY GLAZING TO BE PROVIDED							

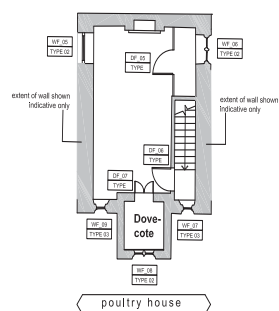
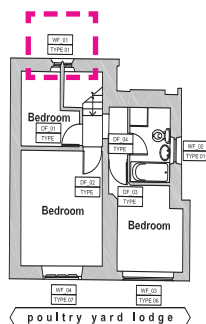

EXISTING EXTERNAL WINDOW SCHEDULE											
Window reference No :						WF-02					
Floor level :		First		External window type :		Type 01					
HISTORICAL SIGNIFICANCE				Level of significance		1=low, 5=high	1	2	3	4	5
Approximate date :		C 1860 & 1900's								4	
Description :				WORKS PROPOSED							
Two panel window with central stone pier and metal framed windows with opening light to LHS				Retained and repaired :		Removed and replaced :					
				YES. SECONDARY GLAZING TO BE PROVIDED							

